

Location Maps:

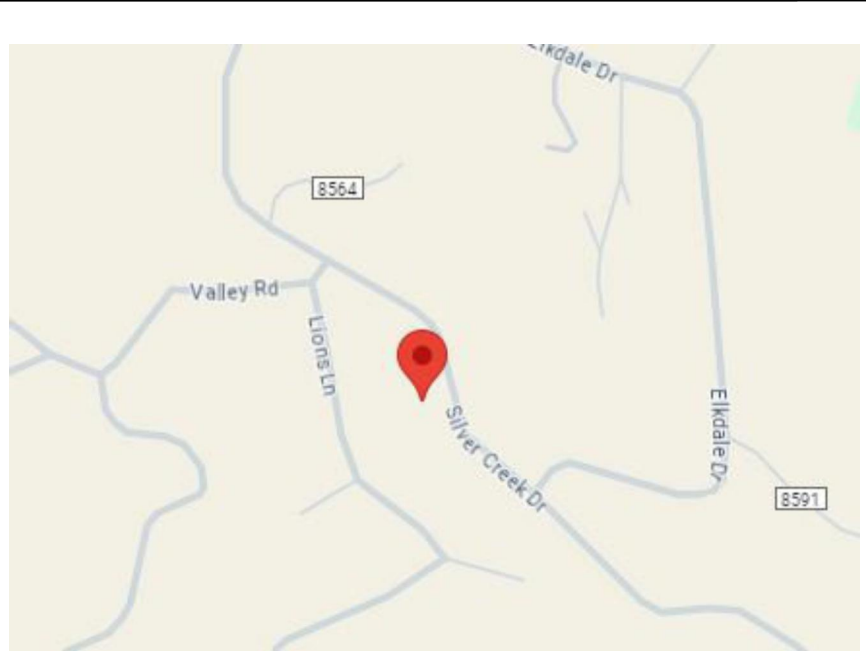

Aerial View:

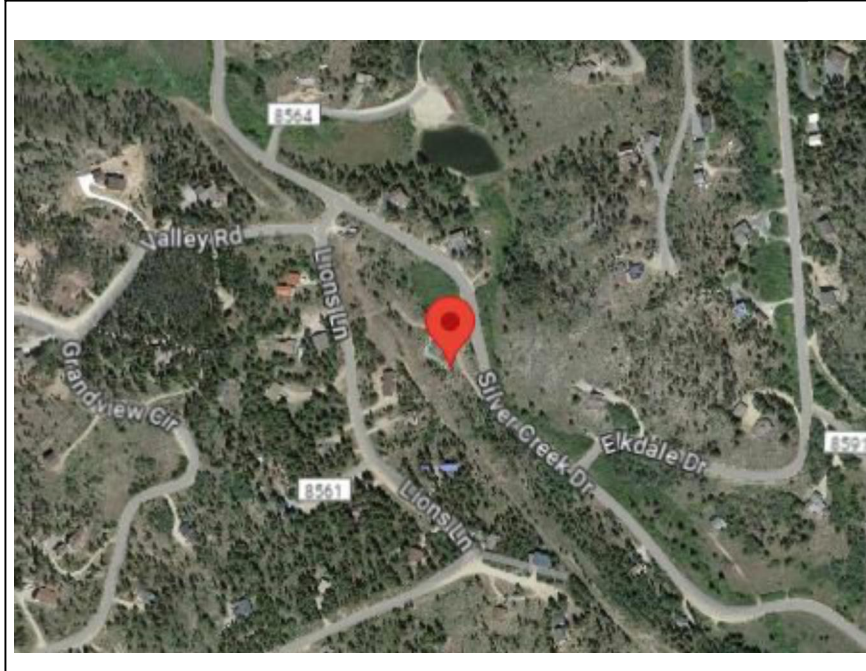

Carport Preview:

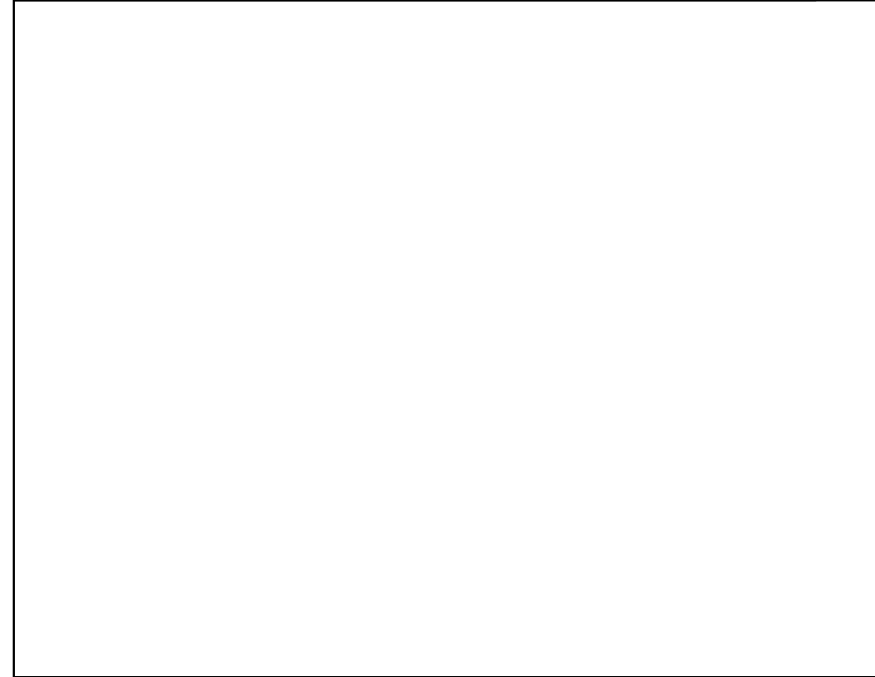

General Notes:

Blank area for general notes.

Scope of work:

CARPORT CONSTRUCTION FOR EXISTING BUILDING

Index:

- 01: COVER PAGE
- 02: FOUNDATION PLAN
- 03: ATTACHMENT PLAN -1
- 04: ATTACHMENT PLAN -2
- 05: CONNECTIONS SHEET
- 06: BILL OF MATERIALS

Contractor Info



Project Type - Photovoltaic

Project Location:

PROJ-2
3210 Silver Creek Dr. Tabernash CO

EMAIL: - NA
TEL: - NA

File Name:
3210 SILVER_COVER PAGE

Sheet Number and Title:
01- COVER PAGE

Sheet Size:
ANSI full bleed B (17.00 x 11.00 Inches)

Drawing history

no.	drawn by	revision	date
----	VA	----	10/15/2024

Design

1 2 3 4 5 6 7 8 9 10 11

A
B
C
D
E
F
G



FOUNDATION CONNECTION

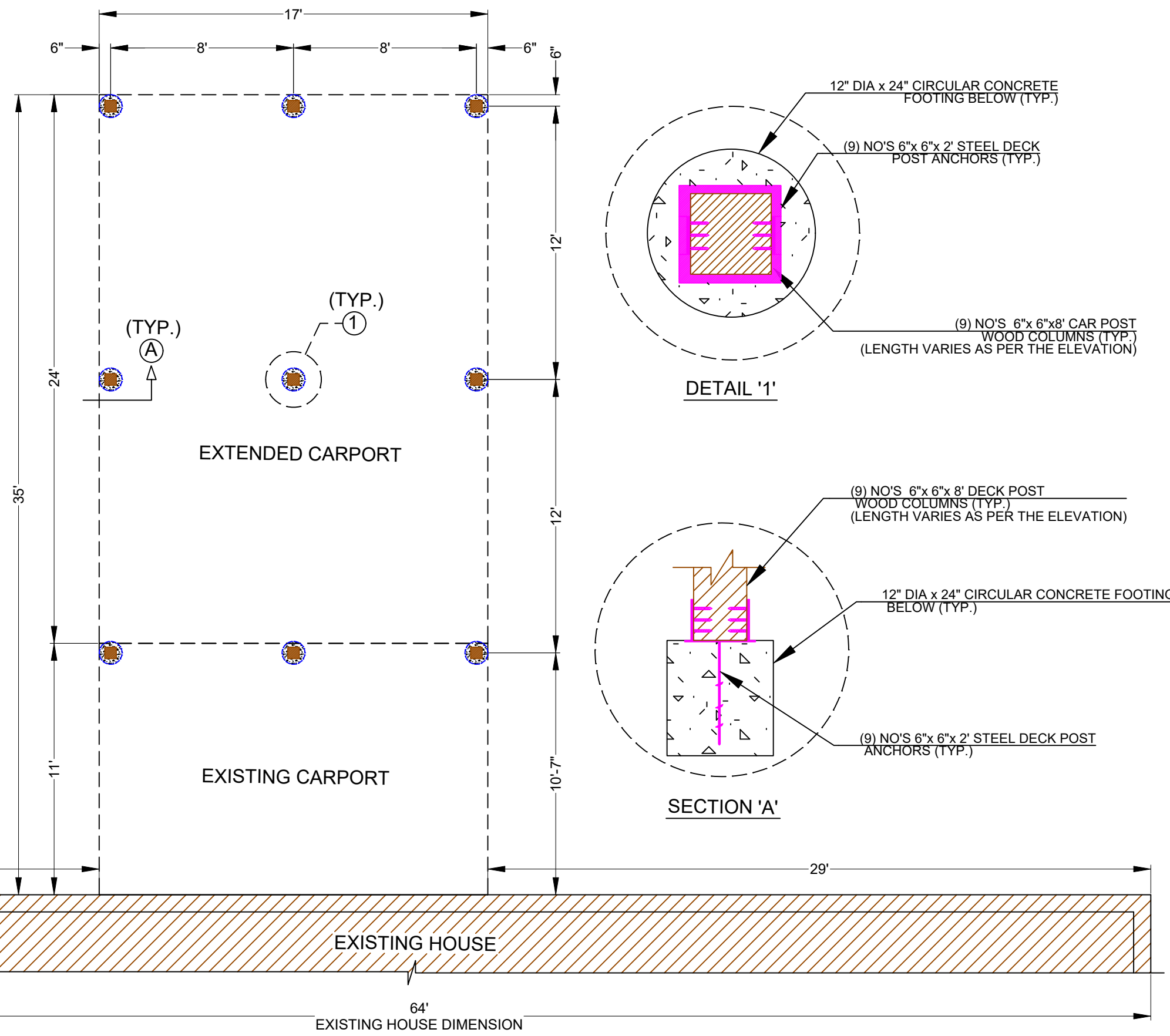

FOUNDATION PLAN

Contractor Info



Project Type - Photovoltaic

Project Location:

PROJ-2
3210 Silver Creek Dr. Tabernash CO

EMAIL: - NA
TEL: - NA

File Name:
3210 SILVER_FOUNDATION PLAN

Sheet Number and Title:
02- FOUNDATION PLAN

Sheet Size:
ANSI full bleed B (17.00 x 11.00 Inches)

Drawing history

no.	drawn by	revision	date
----	VA	----	10/15/2024

Design

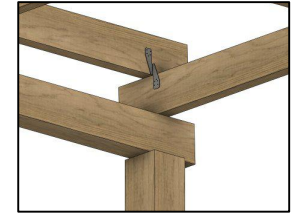
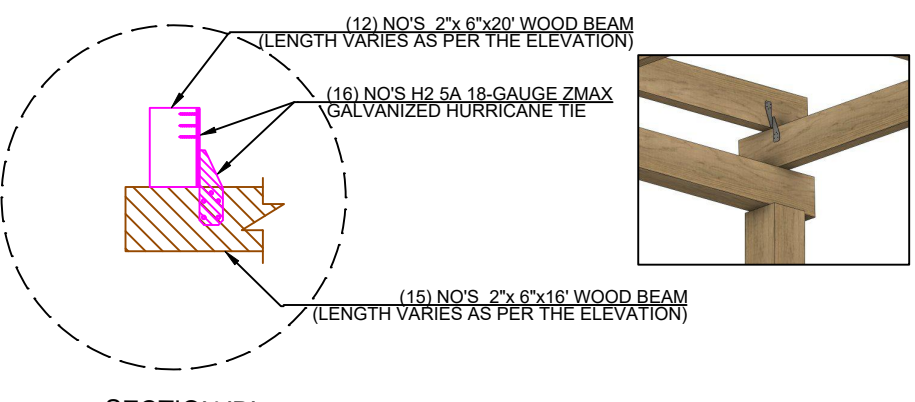
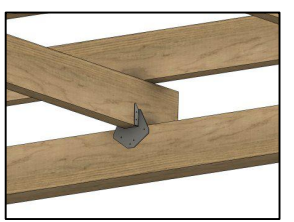
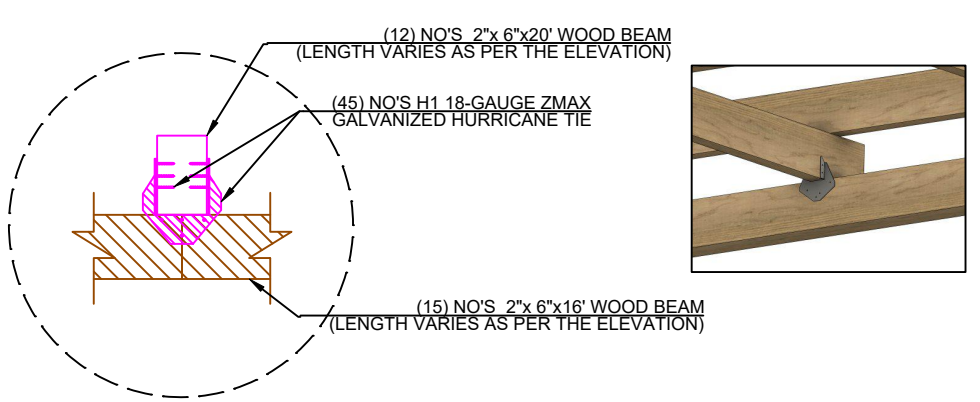
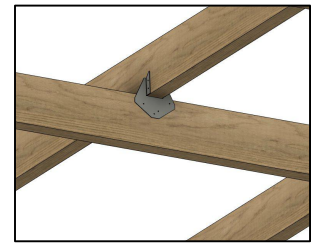
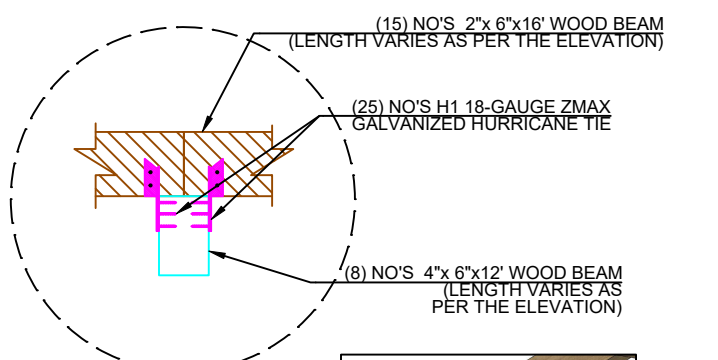
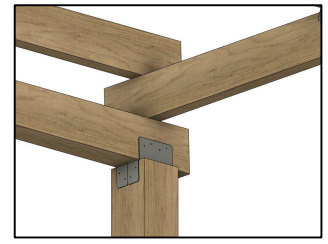
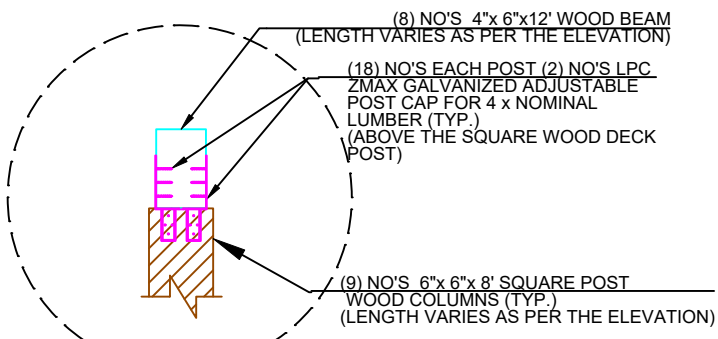
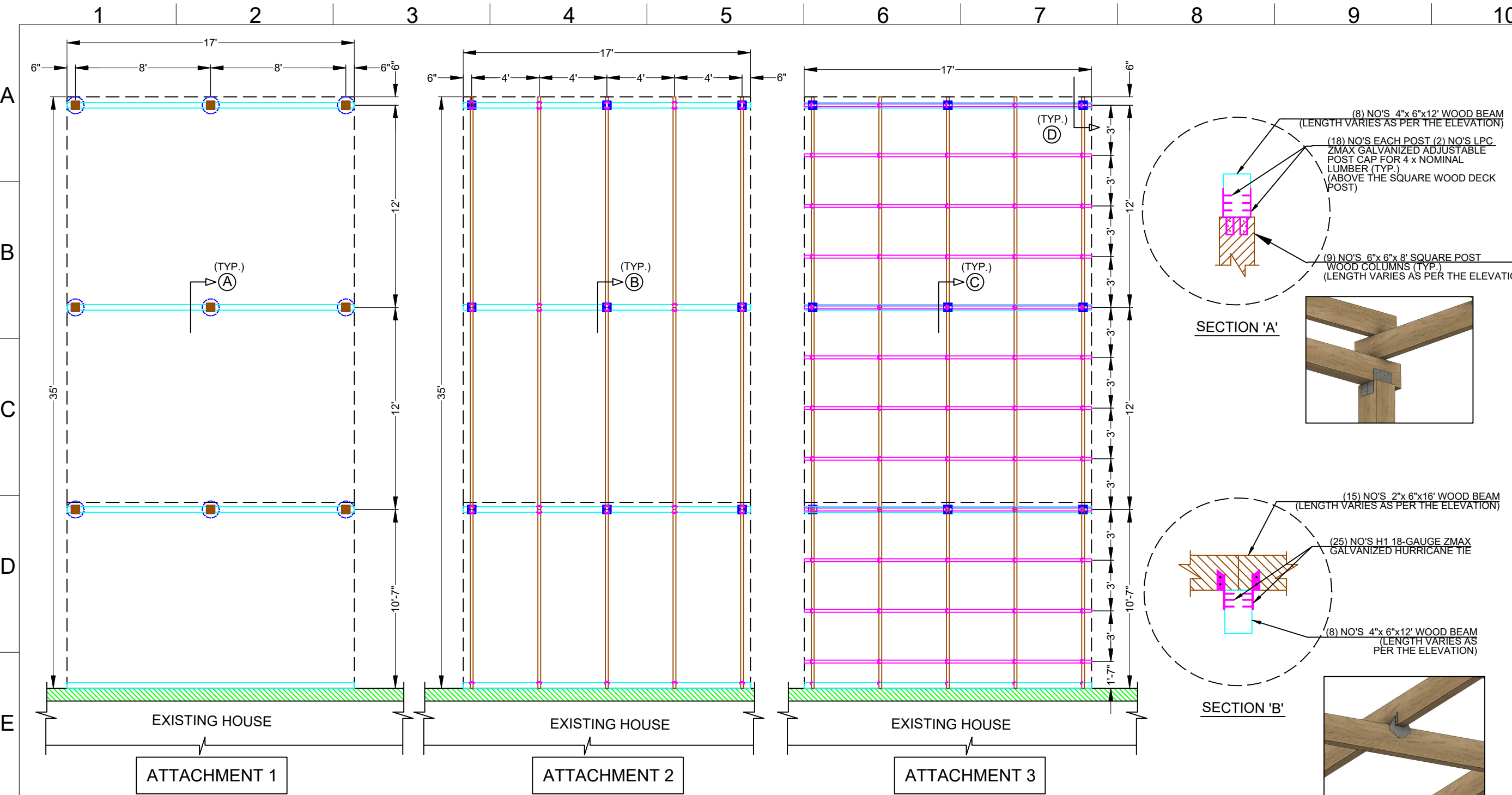

ATTACHMENT PLAN -1

Contractor Info



Project Type - Photovoltaic

Project Location:

PROJ-2
3210 Silver Creek Dr. Tabernash CO
EMAIL: - NA
TEL: - NA

File Name:
3210 SILVER_ATTACHMENT PLAN -1

Sheet Number and Title:
03- ATTACHMENT PLAN -1

Sheet Size:
ANSI full bleed B (17.00 x 11.00 Inches)

Drawing history

no.	drawn by	revision	date
----	VA	----	10/15/2024

Design

-
-
-
-



VIEW -1

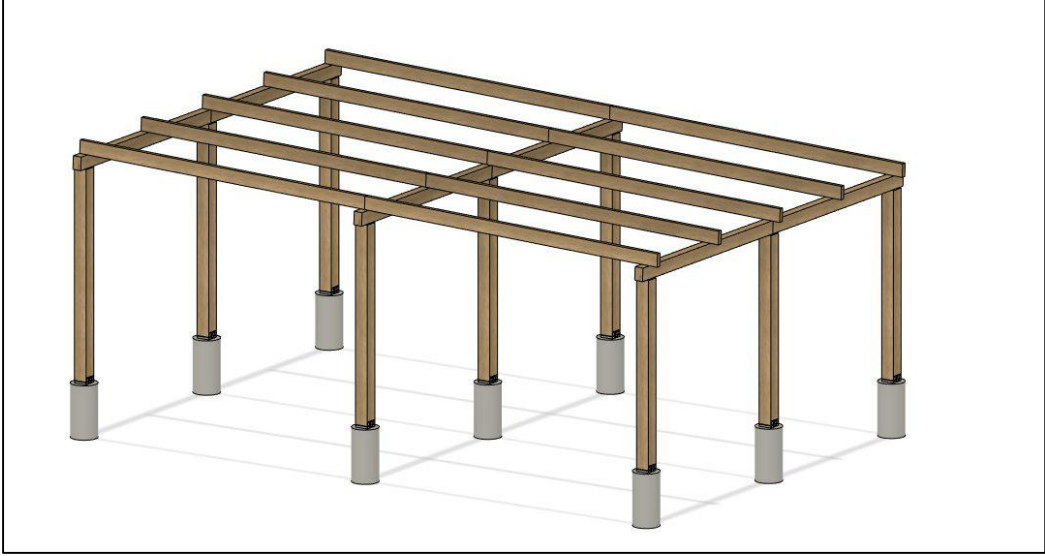

VIEW -2

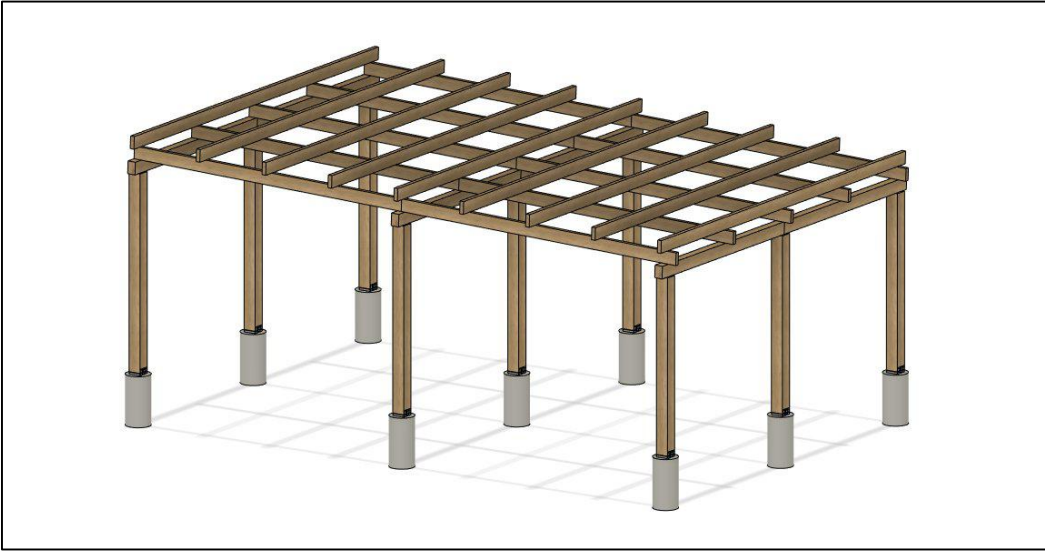

VIEW -3

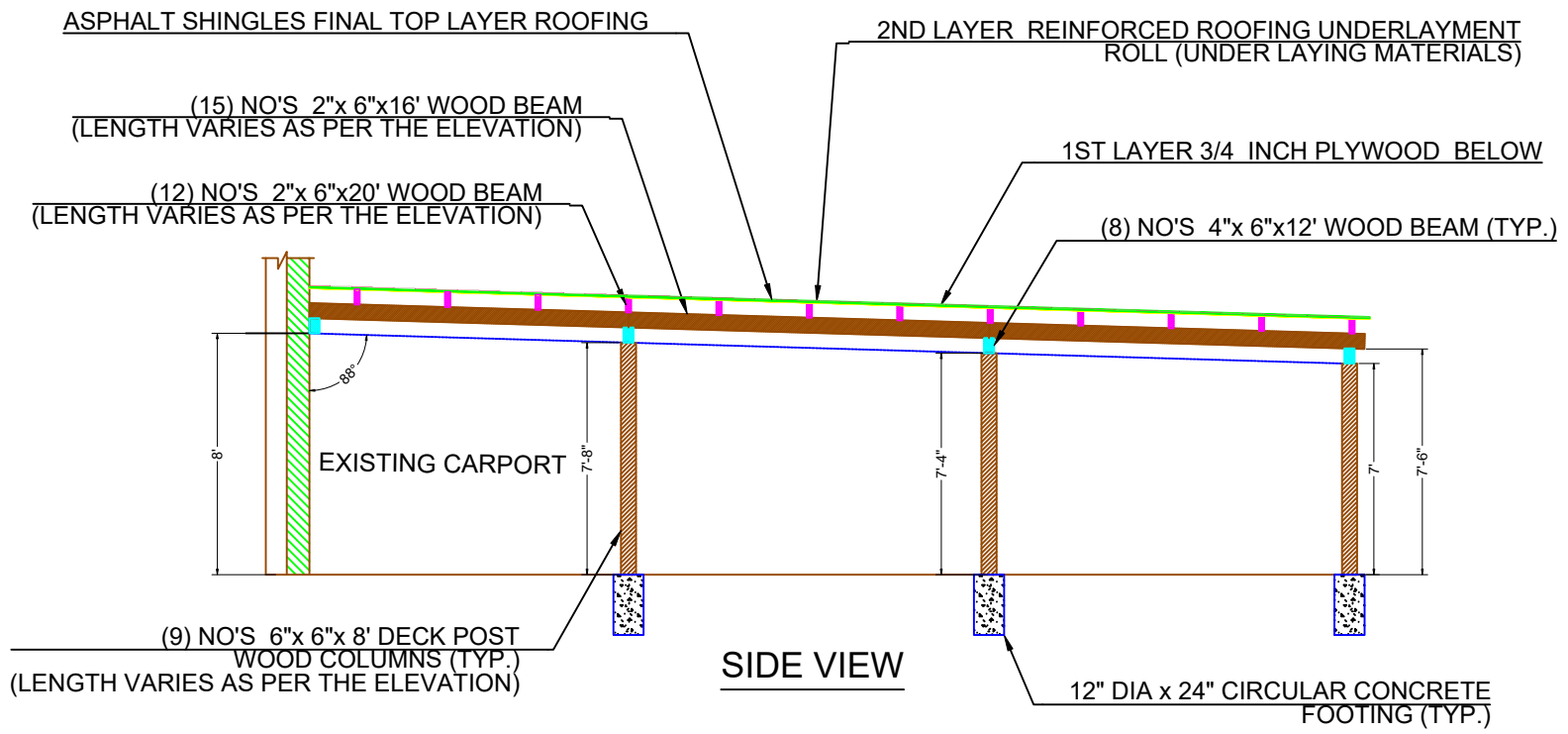

SIDE VIEW

NOTE : DESIGN IS SUBJECT TO CHANGE AS PER CONSTRUCTION CONSTRAINTS INPUT FROM CONTRACTORS.

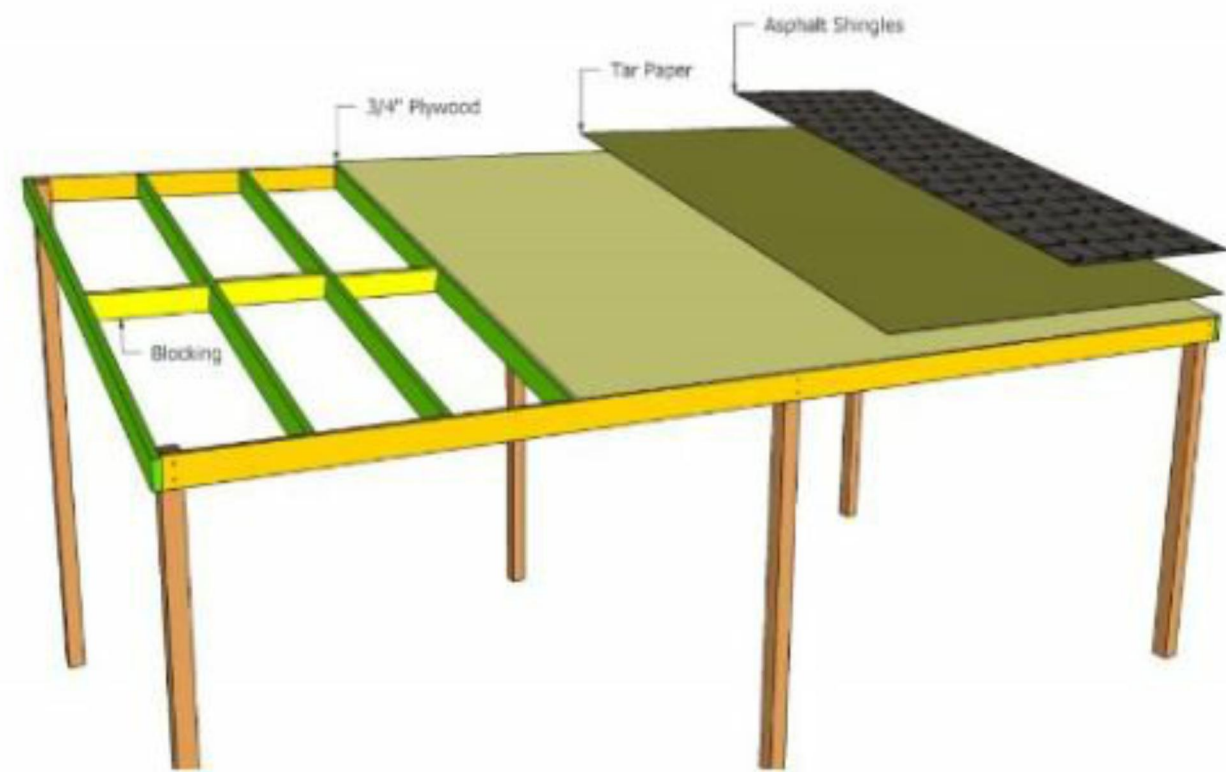

ROOF MATERIALS

Contractor Info



Project Type - Photovoltaic

Project Location:

PROJ-2
3210 Silver Creek Dr. Tabernash CO

EMAIL: - NA
TEL: - NA

File Name:
3210 SILVER_ATTACHMENT PLAN - 2

Sheet Number and Title:
04- ATTACHMENT PLAN - 2

Sheet Size:
ANSI full bleed B (17.00 x 11.00 Inches)

Drawing history

no.	drawn by	revision	date
----	VA	----	10/15/2024

Design

-
-
-
-

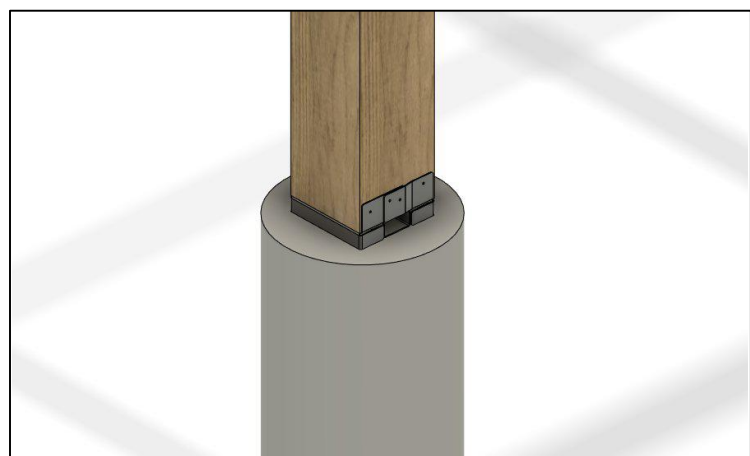

VIEW 1

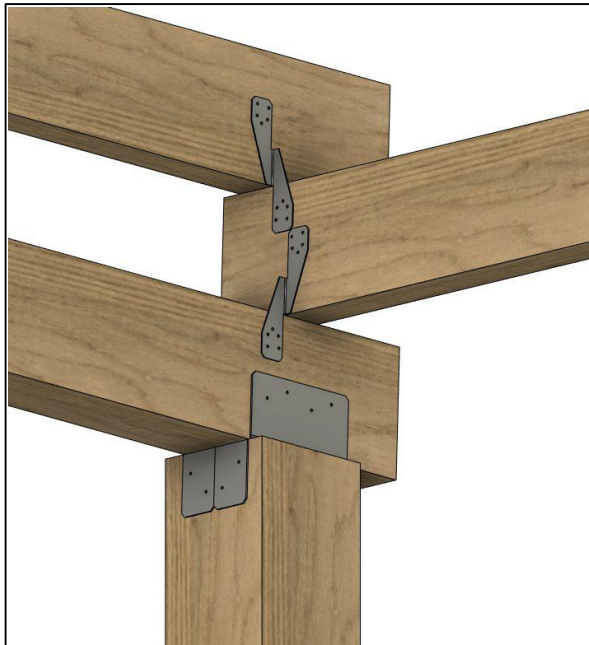

VIEW 4

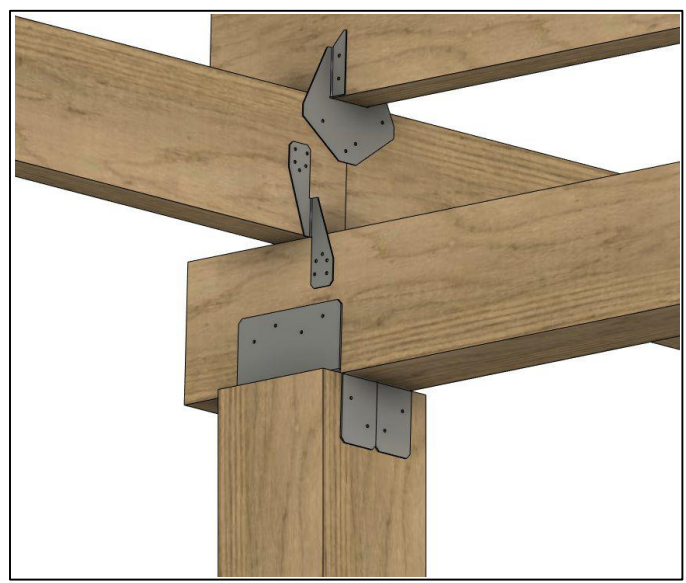

VIEW 6



VIEW 2

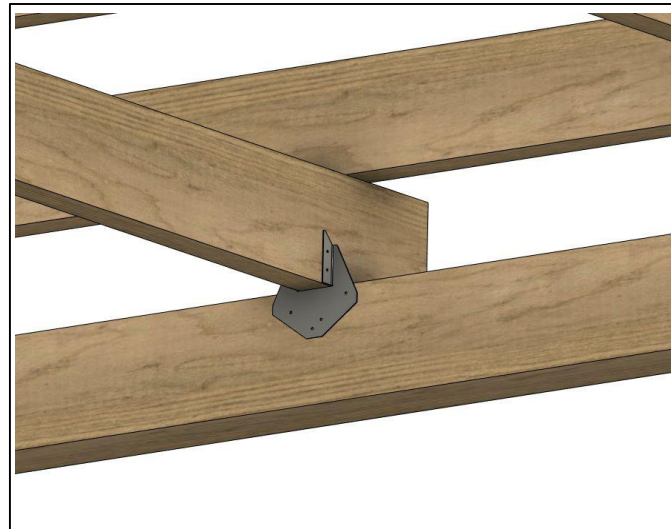

VIEW 5



VIEW 7

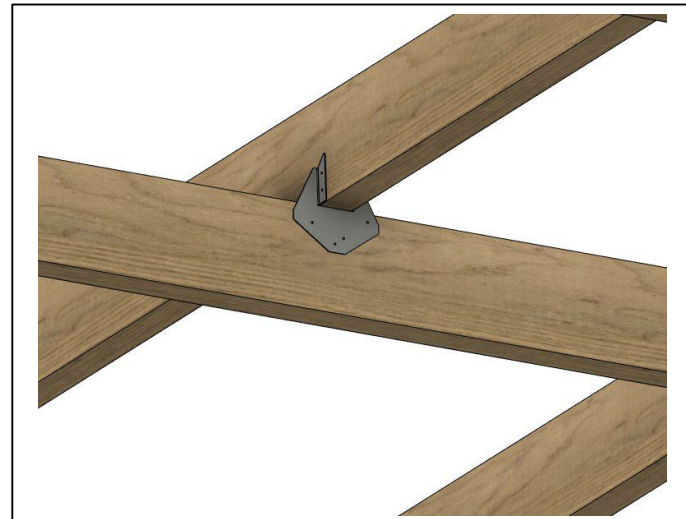

VIEW 3



VIEW 8

CONNECTIONS SHEET

Contractor Info



Project Type - Photovoltaic

Project Location:

PROJ-2
3210 Silver Creek Dr. Tabernash CO

EMAIL: - NA
TEL: - NA

File Name:
3210 SILVER_CONNECTIONS SHEET

Sheet Number and Title:
05- CONNECTIONS SHEET

Sheet Size:
ANSI full bleed B (17.00 x 11.00 Inches)

Drawing history

no.	drawn by	revision	date
----	VA	----	10/15/2024

Design

Contractor Info

Project Type - Photovoltaic

Project Location:

PROJ-2
3210 Silver Creek Dr. Tabernash CO

EMAIL: - NA
TEL: - NA

File Name:
3210 SILVER_BILL OF MATERIALS

Sheet Number and Title:
06- BILL OF MATERIALS

Sheet Size:
ANSI full bleed B (17.00 x 11.00 Inches)

Drawing history

no.	drawn by	revision	date
----	VA	----	10/15/2024

Design

BILL OF MATERIALS							
SL NO.	PART	COMPONENT	DISCRIPTION	QUANTITY	PER QUANTITY MSRP COST	TOTAL COST	PURCHASE LINKS & DOCUMENTS
1.	CARPORT SQUARE POST	CARPORT POST - (Model # 114661) 6 in. x 6 in. x 8 ft. #2 Ground Contact Pressure-Treated Southern Yellow Pine Redwood-Tone Timber	9 Nos to support the Carport from the ground. Directioning from Ground to the vertically to carport beam	9	\$41.38	\$372.42	https://www.homedepot.com/p/6-in-x-6-in-x-8-ft-2-Ground-Contact-Pressure-Treated-Southern-Yellow-Pine-Redwood-Tone-Timber-114661/205034894
2.	SUPPORTING BEAM	CARPORT BEAM - (Model # 150749) 4 in. x 6 in. x 12 ft. #2 Ground Contact Redwood-Tone Pressure-Treated Timber	6 No's supporting beam above the vertical square post horizontally, each row 2 No's 3 rows 6 No's its shown in Cyan colour	6	\$35.78	\$214.68	https://www.homedepot.com/p/4-in-x-6-in-x-12-ft-2-Ground-Contact-Redwood-Tone-Pressure-Treated-Timber-150749/203622014
3.	SUPPORTING JOISTS TYPE 1	CARPORT JOISTS - (Model # 263826) 2 in. x 6 in. x 20 ft. #1 Ground Contact Pressure Treated Redwood-Tone Pine Lumber	9 No's supporting Joists above the horizontal supporting joists, each row 1 No's 9 rows 9 No's its shown in Magenta colour	9	\$26.18	\$235.62	https://www.homedepot.com/p/2-in-x-6-in-x-20-ft-1-Ground-Contact-Pressure-Treated-Redwood-Tone-Pine-Lumber-263826/324972277
4.	SUPPORTING JOISTS TYPE 2	CARPORT JOISTS - (Model # 253904) 2 in. x 6 in. x 16 ft. 1 Redwood-Tone Ground Contact Pressure-Treated Southern Yellow Pine Lumber	10 No's supporting joists above the horizontal supporting beam, each row 2 No's 5 rows 10 No's its shown in wood colour	10	\$18.78	\$187.80	https://www.homedepot.com/p/WeatherShield-2-in-x-6-in-x-16-ft-1-Redwood-Tone-Ground-Contact-Pressure-Treated-Southern-Yellow-Pine-Lumber-253904/206967761
5.	POST ANCHORS TYPE 1	POST ANCHORS - (Model # TIDF662600) 6 in. x 6 in. to 24 in. Steel Deck Foot Anchor	9 Nos of Anchors post , to hold the post on the concrete founation (SECTION A)	9	\$73.00	\$657.00	https://www.homedepot.com/p/6-in-x-6-in-to-24-in-Steel-Deck-Foot-Anchor-TIDF662600/315703226
6.	POST ANCHORS TYPE 2	LPC ZMAX Galvanized Adjustable Post Cap for 6x Nominal Lumber - (Model # LPC6Z)	18 NOs Of Post caps used to attach the post to the Deck beams.shown in (SECTION A)	18	\$7.58	\$136.44	https://www.homedepot.com/p/Simpson-Strong-Tie-LPC-ZMAX-Galvanized-Adjustable-Post-Cap-for-6x-Nominal-Lumber-LPC6Z/100375028
7.	HURRICAN TIE (V SHAPED)	H1 18-Gauge ZMAX Galvanized Hurricane Tie - (Model # H1Z)	70 Nos of V shaped Hurricane tie are used to joint the Joist with the Deck beam Shown in (SECTION B & D)	70	\$1.28	\$89.60	https://www.homedepot.com/p/Simpson-Strong-Tie-H1-18-Gauge-ZMAX-Galvanized-Hurricane-Tie-H1Z/100374935
8.	HURRICAN TIE (HELIX SHAPED)	H8 18-Gauge Stainless-Steel Hurricane Tie - (Model # H8SS)	8 Nos Helix shaped Hurrigan tie used on join Joist and the beam in the corner Shown in (SECTION D)	16	\$9.13	\$146.08	https://www.homedepot.com/p/Simpson-Strong-Tie-H8-18-Gauge-Stainless-Steel-Hurricane-Tie-H8SS/205324375
9.	ROOFING PLYWOOD	3/4 in. x 4 ft. x 8 ft. CC Pressure-Treated Pine Plywood - (Model # 106128)	14 Nos Roofing plywood 1st layer of roofing Shown in (SIDE VIEW)	14	\$50.68	\$709.52	https://www.homedepot.com/p/3-4-in-x-4-ft-x-8-ft-Ground-Contact-Pressure-Treated-Pine-Performance-Rated-Sheathing-Plywood-106128/206971071
10.	SHINGLES	Slateline Weathered Slate Designer Laminated Architectural Shingles (33.3 sq. ft. per Bundle) (16-pieces)	18 Bundles 288 Pieces of single Roofing last final layer of roofing Shown in (SIDE VIEW)	288	\$74.00	\$21,312.00	https://www.homedepot.com/p/GAF-Slateline-Weathered-Slate-Designer-Laminated-Architectural-Shingles-33-3-sq-ft-per-Bundle-16-pieces-0711895/204382448
11.	UNDERLAYMENT	Shingle-Mate 432 sq. ft. Fiberglass-Reinforced Roofing Underlayment Roll	2 Roll of Roofing underlayment above the plywood roofing Shown in (SIDE VIEW)	2	\$85.52	\$171.04	https://www.homedepot.com/p/GAF-Shingle-Mate-432-sq-ft-Fiberglass-Reinforced-Roofing-Underlayment-Roll-0902000/100082965
NOTE: ENTIRE BOM WAS GENERATED BASED ON ENGINEERING CALCULATIONS AND DESIGN.				NUMBER OF COMPONENTS	SUB TOTAL		\$24,232.20
					DELIVERY COST		
NOTE: THE NUMBERS AND THE SIZE OF HANGERS SCREWS AND THE DECKING SCREWS WAS NOT ANALYSED ACCURATELY , THIS COULD BE ACCURATELY DECIDED ON-SITE BASED ON THE REQUIREMENTS.				451	SAVINGS		
					TOTAL COST		\$24,232.20